

## Centennial College Residences and Culinary Arts Centre

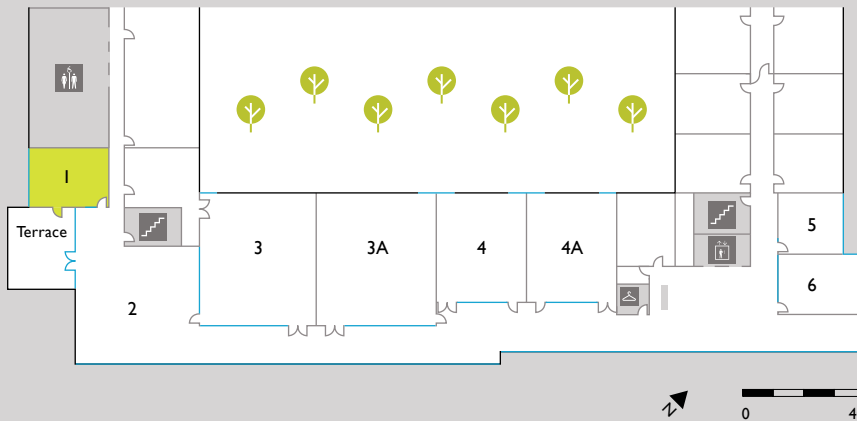

- 1 Private Dining Room**
- 2 West Vista
- 3 Winter Room
- 3A Fall Room
- 4 Summer Room
- 4A Spring Room
- 5 North Boardroom
- 6 South Boardroom

**I**

### PRIVATE DINING ROOM Boardroom Style

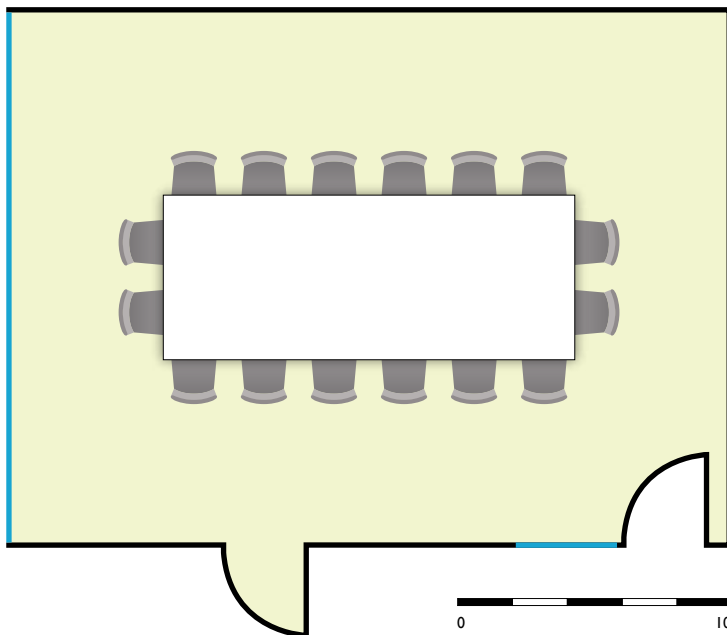

Area: 448' sq

Table Size: 180" x 72"

Quantity: 1

Chair Size: 20" x 24"

Quantity: 16

*Seating configurations shown are for illustrative purposes only. Capacities may also vary based on audio visual and other set up requirements.*